



GUAM POWER AUTHORITY

ATURIDĀT ILEKTRESEDĀT GUĀHAN
P.O.BOX 2977 • HAGĀTŊA, GUAM U.S.A. 96932-2977

May 17, 2023

AMENDMENT NO.: IV

TO

INVITATION FOR BID NO.: GPA-027-23

FOR

GPA INTEGRATED CCTV VIDEO SURVEILLANCE SYSTEMS

Prospective Bidders are hereby notified of the following changes, inclusions and responses to a inquiries received from Bidder No. 4 dated March 27, 2023 and Bidder No. 2 dated April 5, 2023:

CHANGES:

1. **REMOVE** Page 4 of 34 and **REPLACE** with 4a of 34 (see attached).

Under DESCRIPTION, Section **A. SCOPE OF WORK**, item **A.1.4** is changed

FROM:

Supply and secure Secured Network cabinets (42U) with key locks in designated locations.

TO NOW READ:

- * Supply and secure Secured Network cabinets (42U) and (9U) with key locks in designated locations. A secured location at each site must be suggested and final determination made by GPA. A dedicated power outlet must be installed for each rack and secured within each rack. Each rack must also be grounded.

INCLUSIONS:

1. **REMOVE** Page 9 of 34 and **REPLACE** with 9a and 9a.1 of 34 (see attached).

Under DESCRIPTION, Section **C. EQUIPMENT**, add the following:

- ***C.10** 9U Wall Mounted Cabinet
 - Quantity:** 3 Each
 - Location 2 – GPA Dededo Warehouse, Dededo
 - C.10.1** 9U Wall Mount Unit
 - C.10.2** Houses EIA-Standard 19" rack equipment
 - C.10.3** External Dimensions: H 19" x W 24" x D 18"

- C.10.4 Vented Top/Side/Front for adequate air flow
- C.10.5 Shatter-Resistant clear front door window
- C.10.6 Removable side panels
- C.10.7 Front and side lockable panels with set of keys
- C.10.8 Top/Bottom knockouts for cable entries
- C.10.9 Maximum Load 200Lbs
- C.10.10 Enclosure is fully assembled
- C.10.11 5 Year warranty

- * C.11 8 port PoE Gigabit Managed Switch with 2x 1G Copper, 2x10G SFP
Quantity: 2 Each
 Location 2 – GPA Dededo Warehouse, Dededo
 - C.11.1 8 full PoE+ Gigabit Ethernet ports
 - C.11.2 Layer 2 Support/Manageable
 - C.11.3 10/100/1000BaseT/Base-X
 - C.11.4 2x 1G copper, 2x 10G
 - C.11.5 120VAC, 60Hz, 315W HVDC/AC Power
 - C.11.6 Fanless
 - C.11.7 Perpetual Licensing, with subscription to include:
 configuration, 24/365 Technical Support, Software
 Release updates, Advanced Support Analytics
 - C.11.8 Must include Enhanced Limited Life Time Warranty
 (E-LLW)
 - C.11.9 TAA Compliant

Ref. Mfr.: Cisco C9200CX 8Port POE+ 2XGH

**** APPROVED EQUAL TO OR BETTER ****

- * C.12 12 port PoE Gigabit Managed Switch with 2x 1G Copper, 2x10G SFP
Quantity: 1 Each
 Location 2 – GPA Dededo Warehouse, Dededo
 - C.12.1 12 full PoE+ Gigabit Ethernet ports
 - C.12.2 Layer 2 Support/Manageable
 - C.12.3 10/100/1000BaseT/Base-X
 - C.12.4 2x 1G copper, 2x 10G
 - C.12.5 120VAC, 60Hz, 315W HVDC/AC Power
 - C.12.6 Fanless
 - C.12.7 Must include Enhanced Limited Life Time Warranty
 (E-LLW)
 - C.12.8 Perpetual Licensing, with subscription to include:
 configuration, 24/365 Technical Support, Software
 Release updates, Advanced Support Analytics
 - C.12.9 TAA Compliant

Ref. Mfr.: Cisco C9200CX 12Port POE+ 2XGH

**** APPROVED EQUAL TO OR BETTER ****

- * **C.13** APC Smart-UPS 750VA 120V 1U
 - Quantity:** 3 Each
 - Location 2 – GPA Dededo Warehouse, Dededo
 - C.13.1** Input: 120VAC, 60Hz +/- 3Hz Auto Sensing
 - C.13.2** Output: Max Power 750VA, Line Interactive
 - C.13.3** Replaceable lead-acid battery
 - C.13.4** Interface ports: DB-9 RS-232, USB
 - C.13.5** LED Control Panel
 - C.13.6** 2 Year Warranty, (Repair/Replacement)

**** APPROVED EQUAL TO OR BETTER ****

Bidder No.: 4 dated 03/27/2023:

QUESTION:

1. The Network Recorder that RFP specified has 24TB of storage. Please confirm if it meets the "Provide storage capacity for 24 hours' duration with 30-day period" requirement?

ANSWER:

The 24TB storage was based on **12 cameras configured for Julale**. Dededo Warehouse requirements are 24 Cameras which will require a total of 125TB storage @24hr/day for 30 days. Cabras Warehouse requirements are 14 cameras which will require 75TB storage. Transportation requirements are 6 Cameras which will require 35TB storage.

QUESTION:

2. RFP requesting for 90-watt PoE injectors which is much more than for the type of camera specified. Can GPA accept POE injectors that will make the system operational ? Also, PoE injectors are not required unless the cameras are beyond 330. Ethernet switches already has PoE outputs, and which can make the system operational. Please confirm if these are acceptable.

ANSWER:

- a. Yes, GPA will accept PoE injectors that will meet the requirements of the cameras, ie, IEEE802.3af/802.3at Type 1 Class 3.
- b. Yes, power injectors boost power on devices beyond 330ft, (100m) for a single device.

Bidder No.: 2 dated 04/05/2023:

QUESTION:

1. Please, provide the Cisco switch model number to be quoted on this RFP for all locations.

ANSWER:

Bidder must submit and qualify a Cisco Switch that must support the requirements specified.

QUESTION:

2. During the site assessment at the Dededo warehouse, building C and D have switches to accommodate the cameras on the building each and from there one Cat5e cable was used to transmit back to the headend. What is the size of the conduits that were installed between the buildings and are we to provide the additional switches at both buildings like what is currently in place?

ANSWER:

- a. Yes, Building C&D will require additional switch and rack for their locations. Kindly refer to **INCLUSIONS** above.
- b. It was discovered that the current data cabling runs in 1 inch conduits.

QUESTION:

3. It was mentioned on at the pre-bid that plan or pictures will be provide upon request, please provide floor plans that show camera locations.

ANSWER:

Kindly see attached floor plans with referenced cameras and equipment.

QUESTION:

4. It was not shown to the contractor at the Julale Customer Service, where the additional cameras were to be installed at. Please, provide floor layout indicating locations.

ANSWER:

Specifically, for Julale, no additional cameras will be installed. Installation of 8 cameras only at the existing locations. Remaining 4 cameras to be turned over to GPA and held for future use upon office renovations. All 12 cameras are to be configured.

All other Terms and Conditions in the bid package shall remain unchanged and in full force.

for JOHN M. BENAVENTE, P.E.
General Manager

INVITATION FOR BID NO.: GPA-027-23
Requisition No.: 37025

NO.	DESCRIPTION	U/I	TOTAL:
-----	-------------	-----	--------

1.0	The Guam Power Authority (GPA) is requesting proposals to provide complete IP based, NDAA and ONVIF Compliant, CCTV Integrated Video Surveillance Network turnkey solutions individually, at four GPA facilities, Julale Customer Service Center, Dededo Warehouse, Cabras Warehouse and Transportation Supply Room. The solutions shall comprise of IP based PoE Video Cameras, Client/Server CCTV Integrated Network Video Recording System, Video Management Software with Remote Clients, network equipment, with all supplementary materials necessary for a complete and functioning system.	L	\$ _____
-----	--	---	----------

This solution is a critical component with our security strategy as it improves the security posture, crime deterrent, and minimizes possible threats and risks to customers, personnel and property.

Specific components for the NVRs and cameras are required in this project for the future tie-in to an enterprise CCTV system that ties back to a Central Alarm Station housed at Fadian Main Office. The Enterprise CCTV system is currently being installed at multiple facilities under a separate project for Physical Security as a Proof of Concept with the intention of continuing through additional phases of design and installation at other substations and generation facilities. This is part of the GPA initiative to centralize Security alarm detection, assessment and response and improving our overall security posture with designed defense-in-depth for critical asset areas.

COMPLY:

NOT COMPLY:

Comply must be identified below.
All deviations must be identified below.

A. SCOPE OF SERVICES:

- A.1 To procure Supply, Install, Deploy and Support all hardware and software necessary for fully functional CCTV Video Surveillance Systems and network infrastructure at the four line itemed locations as follows: Location 1 - Julale Customer Service Center, Location 2 - Dededo Warehouse, Location 3 - Cabras Warehouse and Location 4 - Transportation Supply Room. To provide manufacturer warranty service and support for period of three (3) years. To provide user training on software configurations, operational and administrative functions, to include; live views, recordings, playbacks, and monitoring of images and footages.
 - A.1.1 Site survey and feasibility shall be undertaken for identification, and placements of Cameras, Network Cabinet, Network Infrastructure devices and Identification of devices for removal.
 - A.1.2 Supply, install, configure and deploy all the hardware for implementation of a fully functional IP based CCTV Video Surveillance System with a Battery Backup solution to support the entire CCTV System. Provision of storage capacity for 24hours duration for 30-day period.
 - A.1.3 Supply all materials and accessories (data cables, connectors, screws, clamps, fasteners, ties, etc.) required for installation of all required items for implementation of the CCTV Video Surveillance System. Run and terminate all data cables from each camera to the MDF, terminate and certify each UTP CAT6 cable run with no less than ANSI/TIA 568B standards.
 - *A.1.4 Supply and secure Secured Network cabinets (42U) and (9U) with key locks in designated locations. A secured location at each site must be suggested and final determination made by GPA. A dedicated power outlet must be installed for each rack and secured within each rack. Each rack must also be grounded.

_____	_____
_____	_____
_____	_____
_____	_____
_____	_____

SPECIFICATIONS GENERATED BY:
Kenneth J. Gutierrez
Digitally signed by Kenneth J. Gutierrez
Date: 2023.05.05 12:44:19 +10'00'

SPECIFICATIONS REVIEWED/CONCURRED BY:
James C. Borja
Digitally signed by James C. Borja
Date: 2023.05.16 11:43:52 +10'00'

SPECIFICATIONS APPROVED BY:

KENNETH J. GUTIERREZ Date
Safety & Physical Security Manager

JAMES C. BORJA Date
Utility Services Administrator

BEATRICE P. LIMTIACO Date
Assistant General Manager of Administrator

 05/09/2023
RUDOLPHO C. MANIBUSAN Date
Computer Technician Supervisor

INVITATION FOR BID NO.: GPA-027-23
Requisition No.: 37025

NO.	DESCRIPTION	U/I	TOTAL:
			<div style="display: flex; justify-content: space-around;"> <div style="border: 1px solid black; padding: 2px;">COMPLY:</div> <div style="border: 1px solid black; padding: 2px;">NOT COMPLY:</div> </div> <p>Comply must be identified below. All deviations must be identified below.</p>
C.8	42U Secured Cabinet (Rack): Quantity: 1 Each Per Location: Location 1 – GPWA Customer Service Center-Julale, Hagatna Location 2 – GPA Dededo Warehouse, Dededo Location 3 – GPA Cabras Warehouse, Piti Location 4 – GPA Transportation Supply Room, Tamuning		
C.8.1	42U Heavy Duty Rack Enclosure Cabinet to accommodate 19-inch rackmount equipment		
C.8.2	Locking removable, reversible front and rear doors		
C.8.3	Locking removable side panels keyed alike with doors		
C.8.4	Meets all enclosure requirements of PCI DSS compliance		
C.8.5	5 year manufacturer warranty		
C.9	1U Switched Rack Power Distribution Unit: Quantity: 1 Each Per Location: Location 1 – GPWA Customer Service Center-Julale, Hagatna Location 2 – GPA Dededo Warehouse, Dededo Location 3 – GPA Cabras Warehouse, Piti Location 4 – GPA Transportation Supply Room, Tamuning		
C.9.1	Input: NEMA L5-20P		
C.9.2	Horizontal 1U Switched PDU		
C.9.3	Outlets: 8 NEMA 5-20R		
C.9.4	On/Off Control		
C.9.5	10Ft Power Cord		
* C.10	9U Wall Mounted Cabinet Quantity: 3 Each Location 2 – GPA Dededo Warehouse, Dededo		
C.10.1	9U Wall Mount Unit		
C.10.2	Houses EIA-Standard 19" rack equipment		
C.10.3	External Dimensions: H 19" x W 24" x D 18"		
C.10.4	Vented Top/Side/Front for adequate air flow		
C.10.5	Shatter-Resistant clear front door window		
C.10.6	Removable side panels		
C.10.7	Front and side lockable panels with set of keys		
C.10.8	Top/Bottom knockouts for cable entries		
C.10.9	Maximum Load 200Lbs		
C.10.10	Enclosure is fully assembled		
C.10.11	5 Year warranty		
* C.11	8 port PoE Gigabit Managed Switch with 2x 1G Copper, 2x10G SFP Quantity: 2 Each Location 2 – GPA Dededo Warehouse, Dededo		
C.11.1	8 full PoE+ Gigabit Ethernet ports		
C.11.2	Layer 2 Support/Manageable		
C.11.3	10/100/1000BaseT/Base-X		
C.11.4	2x 1G copper, 2x 10G		
C.11.5	120VAC, 60Hz, 315W HVDC/AC Power		
C.11.6	Fanless		
C.11.7	Perpetual Licensing, with subscription to include: configuration, 24/365 Technical Support, Software Release updates, Advanced Support Analytics		

SPECIFICATIONS GENERATED BY:
Kenneth J. Gutierrez
Digitally signed by Kenneth J. Gutierrez
Date: 2023.05.05 12:43:54 +10'00'

SPECIFICATIONS REVIEWED/CONCURRED BY:
James C. Borja
Digitally signed by James C. Borja
Date: 2023.05.16 11:43:18 +10'00'

SPECIFICATIONS APPROVED BY:

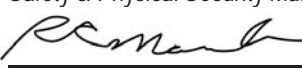
RUDOLPHO C. MANIBUSAN Date 05/09/2023
Computer Technician Supervisor



JAMES C. BORJA Date
Utility Services Administrator

BEATRICE P. LIMITIACO Date
Assistant General Manager of Administrator

Hagatna Office

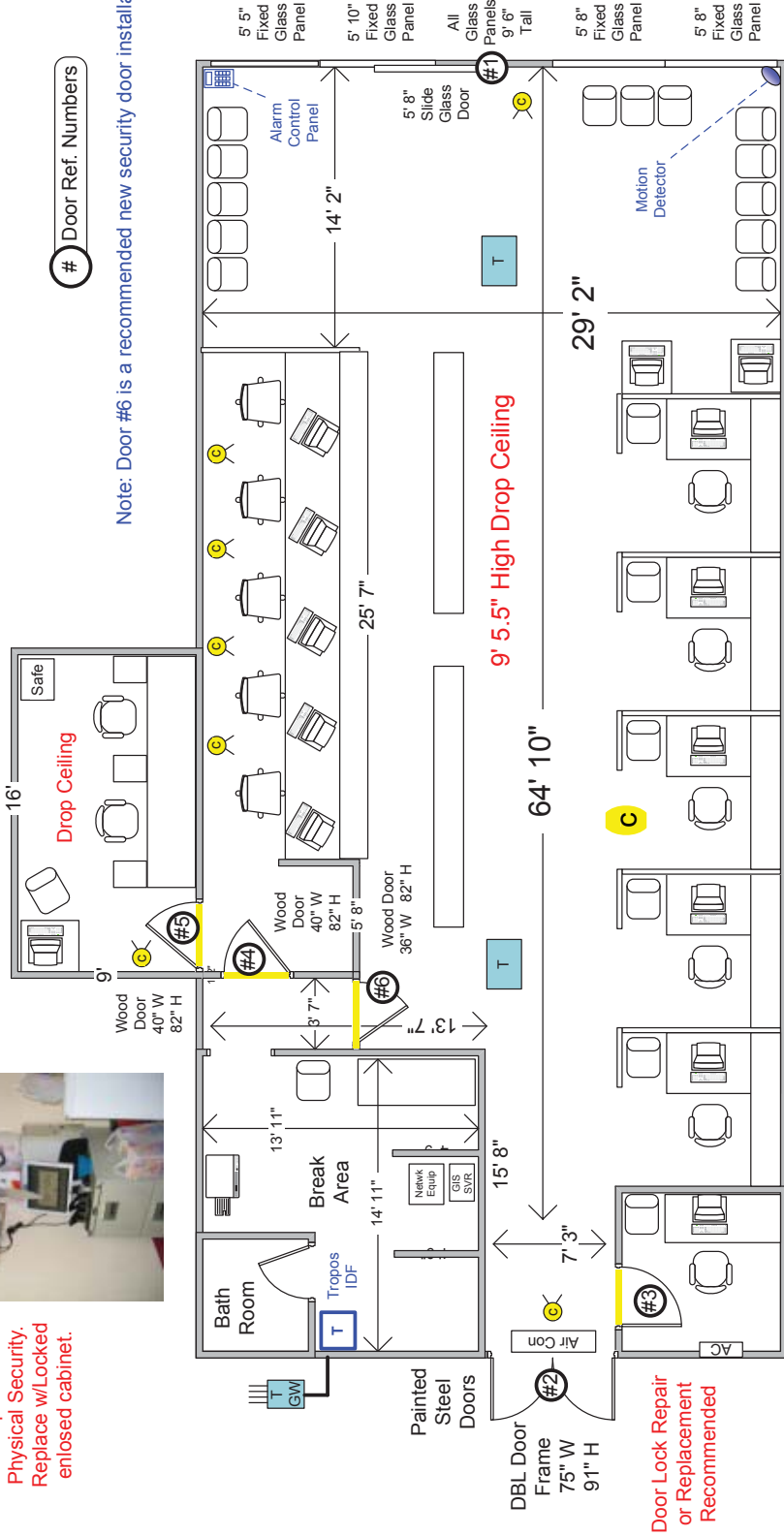

Open Rack does not provide Physical Security. Replace w/Locked enclosed cabinet.



Door Ref. Numbers

Note: Door #46 is a recommended new security door installation for consideration



Yellow highlighted Doorways indicate doors identified to receive ACS device installations

Included in this plan:

- In Indoor Video Cameras
- In Indoor Tropos wireless routers
- In Tropos outdoor wireless Gateway Router

Salvage Yard

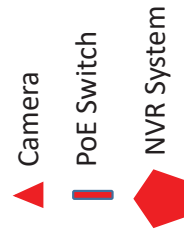
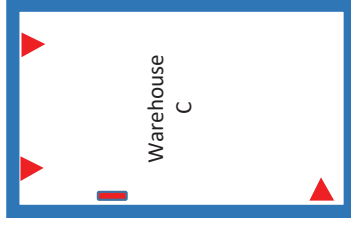
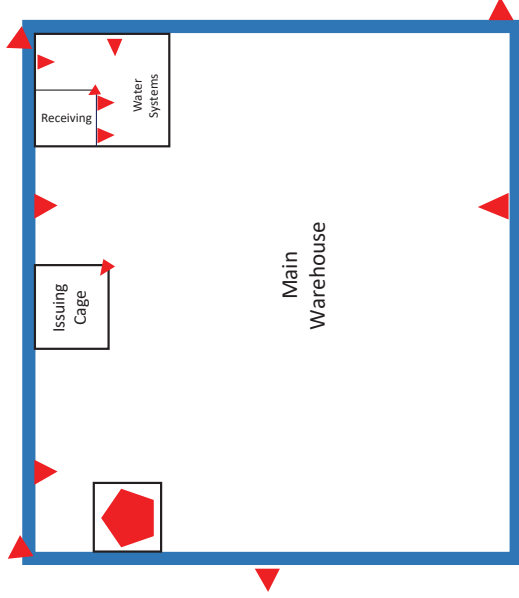
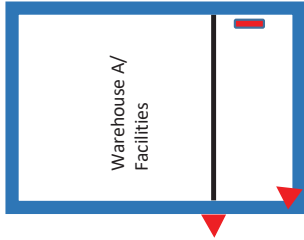

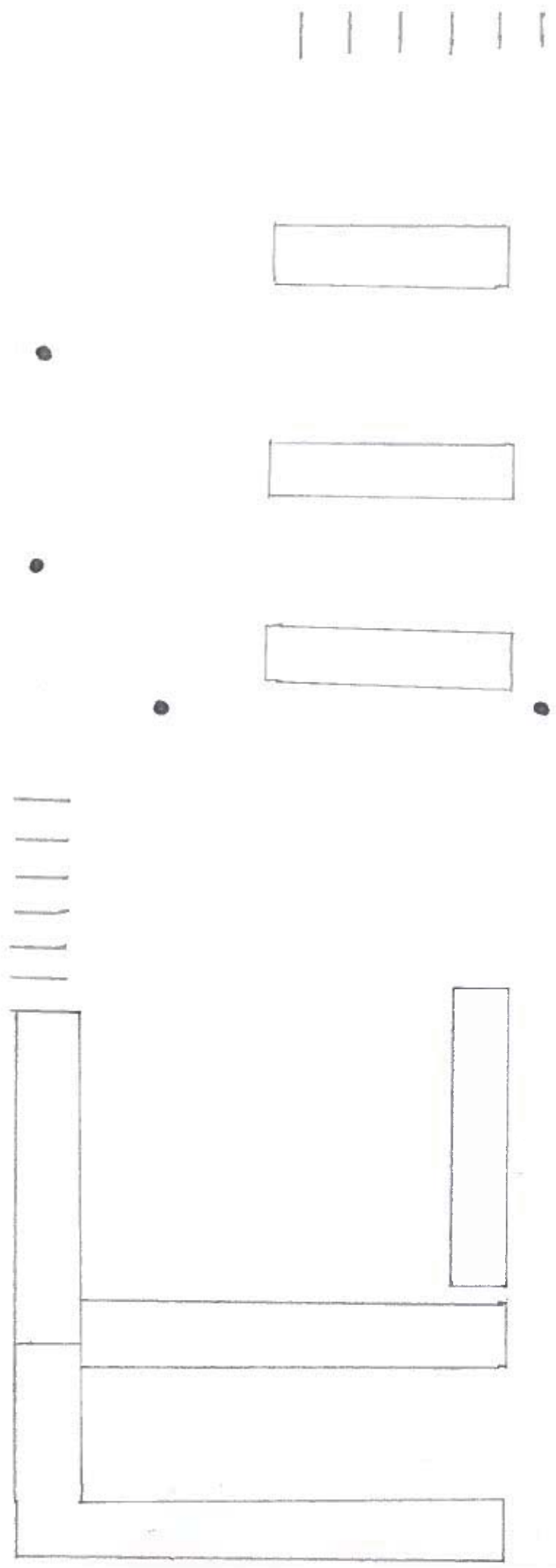

CABRAS 1st FLOOR

- - CAMERA
- * - NVR SYSTEM

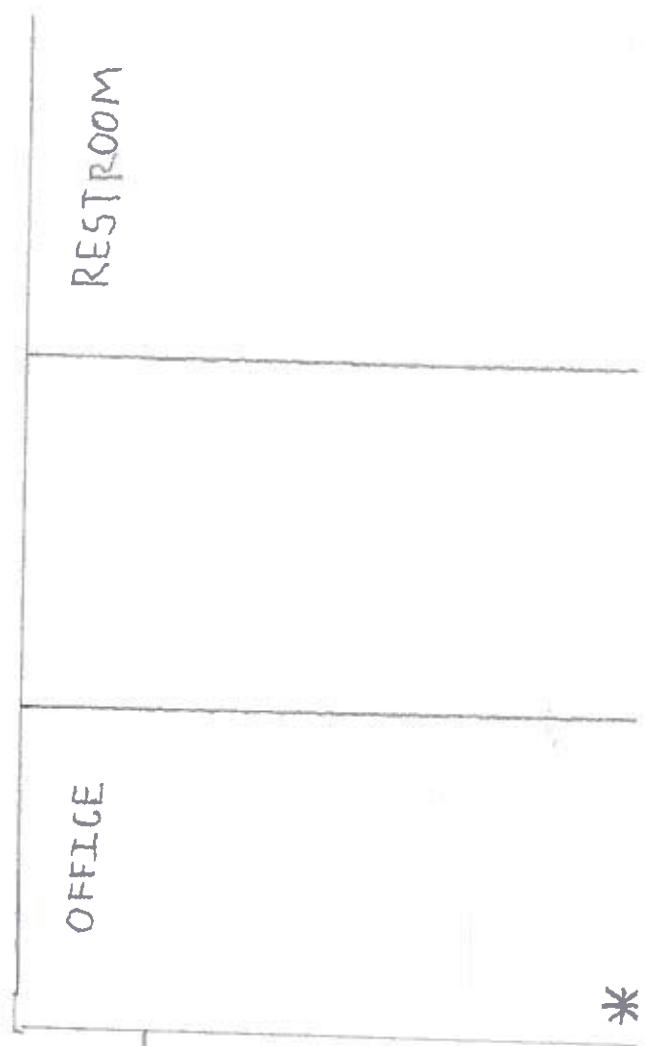

EXIT



CABRAS 2nd FLOOR

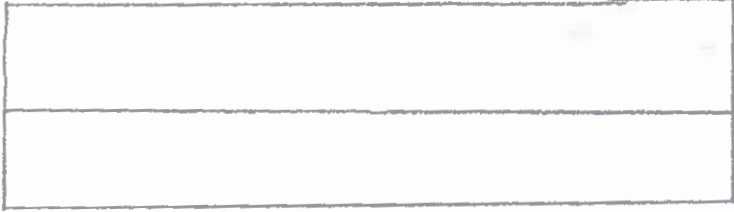
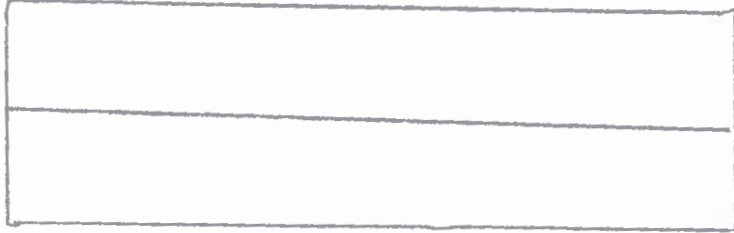
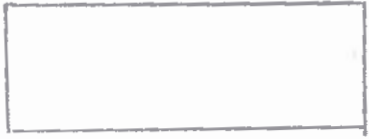

EXIT



SALVAGE YARD

LUBE CAGE

SALVAGE
CAGE

TRANSPORTATION TOOL ROOM

AWNING/ GARAGE

EXIT

PARKING

● - CAMERAS

* - MIN CURTAIN

